

CALIFORNIA DEPARTMENT OF FISH AND GAME

STREAM SURVEY

FILE FORM

No.....

NAME..... SODA CREEK..... COUNTY..... MENDOCINO.....

STREAM SECTION.....FROM.....Mouth.....TO.....Extreme Headwater.....LENGTH.....4 miles.....

TRIBUTARY TO.....Dougherty Creek.....Twp.....16N.....R.....14W.....Sec.....19.....

OTHER NAMES.....Unknown.....RIVER SYSTEM.....BIG RIVER.....

SOURCES OF DATA.....Personal Observation.....

EXTENT OF OBSERVATION Include Name of Surveyor, Date, Etc.
LOCATION
RELATION TO OTHER WATERS
GENERAL DESCRIPTION
Watershed
Immediate Drainage Basin
Altitude (Range)
Gradient
Width
Depth
Flow (Range)
Velocity
Bottom
Spawning Areas
Pools
Shelter
Barriers
Diversions
Temperatures
Food
Aquatic Plants
Winter Conditions
Pollution
Springs
FISHES PRESENT AND SUCCESS
OTHER VERTEBRATES
FISHING INTENSITY
OTHER RECREATIONAL USE
ACCESSIBILITY
OWNERSHIP
POSTED OR OPEN
IMPROVEMENTS
PAST STOCKING
GENERAL ESTIMATE
RECOMMENDED MANAGEMENT
SKETCH MAP
REFERENCES AND MAPS

Extent of Observation: This stream was walked out from the mouth to extreme headwaters, a distance of 4 miles on August 11, 1959 by Stanley N, Nye.

Location: This stream rises just east of the Linn place, flows south then west by north then west by south and enters Dougherty Creek about 2 miles above the confluence of Dougherty and South Fork of Big River about 7 miles west of Orr Springs.

Relation to Other Waters: A larger tributary of Dougherty Creek, of no importance for spawning or nursery. due to barriers,

General Description: Watershed - a typical heavily wooded redwood/ douglas fir, rugged mountainous coastal drainage.

Immediate Drainage Basin: Stream flows through a steep sided V shaped canyon which widens out to a U shape canyon in spots. This area was once heavily wooded and is now logged over. Forest consists of redwood douglas fir, madrone, samal, tanoak, willow, and some alder.

Altitude: Unknown.

Gradient: Moderate in lower area, becoming steep in the upper area,

Width: Average - 2 ft. (8" to 10').

Depth: Average - 2" (1" to 6"),

Flow: Average - .2 cfs (.11 cfs to .25 cfs).

Velocity: Rapid throughout, sluggish in heavily silted spots,

Bottom: Gravel, bedrock, rubble, silt in the upper area and behind Barrier.

Spawning areas: Good throughout lower and middle area. Upper area has only a few scattered spots of gravel due to siltation.

Pools: Abundant - average 3' x 4' x 1' (2' x 3' x 6" to 20' x 20' x 4').

Shelter: Good throughout with overhanging stream side growth and trees.

Barriers - Listed separately.

Diversions: None seen.

Temperatures: Air average - 70° (65 - 73) Water average - 58 (57 - 58).

Food: Common - maze - stone - cadis fly, diptra, larva, stickles and unidentified bugs.

Aquatic Plants: Horsetails, rush, cattails, ferns around silted area.

Winter Conditions: Mild, subject to normal fluctuating runoffs.

Pollution: Logging damage.

Springs Uncommon.

Fish Present and Success: None, due to barrier near the mouth #19. otherwise below the barrier - fish of the year present - average 2".

Other Vertebrates: Frogs - uncommon, salamanders - uncommon.

Fishing Intensity: Unknown.

Other Recreational Use: Unknown.

Accessibility: 20 Miles to Dougherty Creek west of Ukiah on Orr Springs Road. 22 miles up Dougherty Creek road to mouth of Soda Creek, walk from there. Found road to headwaters from Linn Place.

Ownership: Linn, Union Lumber Company - other unknown.

Posted or Open: Posted.

Improvements: None seen.

Past stocking: Unknown.

General Estimate: The Creek has received heavy logging damage in the upper area with heavily silting, extensive jams, barriers, slash and debris. The middle and lower sections are in fair condition but with some jams and barriers. All tributaries are of no fishery value due to the steep gradient, lack of water, jams and barriers and lack of spawning areas. The lower and middle areas have many bedrock outcroppings and gravel available, Use of the upper area at present is non existant due to heavy logging damage.

Recommended Management: Removal of bed rock barrier by blasting and removal of log jams, slash and debris and a general stream clean up. The stream then, if it cleans out, could be managed as an anadromous fishery spawning and nursery area.

Sketch Map: See attached,

References and Maps: Personal observations and C.D. F. 1948 Mendocino County South half -Map

SODA CREEK

Jams and Barriers

1. 1/8 mile area - steep gradient - heavily jammed with fallen logs, slash and debris heavily silted in-no estimate - headwater area.
2. Log bridge jam - silted in - 20 ft wide 4 ft long 4 ft high - 50% void area just below #1 - below headwater forks area.
3. Log jam - silted in barrier - bed drop 3 ft - 25 ft wide 30 ft long 4 ft high 90% void area - mouth of highest southern tributary.
4. Area of intermittent and extensive log jams, slash and debris and fallen logs heavily silted in-no estimate try from #2 down to picnic area.
5. An area 1/8 mile long from just below picnic area down - filled with falls, jams, barriers - heavily silted in-no try at estimate.
6. A natural rock falls - barrier - bed drop 6 ft - 8 ft wide 5 ft long 6 ft high 5% void - 1/2 mile below picnic area.
7. An area 100 yards long - 3/4 mile downstream of picnic area - continuous slash; -minor jams, logs and debris - no estimate.
8. Log bridge silted in barrier - bed drop 3 ft - 200 yards below #7 -20 ft wide 10 ft long 4 ft high - 85% void area.
9. Log jam and barrier - silted in - bed drop 3 ft - road crossing - 1 mile below picnic area - 20 ft wide 40 ft long 6 ft high - 99% void area,
10. Log jam and barrier - silted in - bed drop 3 ft - 100 yards below #9 -10 ft wide 10 ft long 5 ft high - 95% void area,
11. Log jam and barrier - silted in - bed drop 3 ft - 100 yards below #10 -10 ft wide 20 ft long 5 ft high - 95% void area.
12. An area about 100 yards long - 100 yards below #11 - filled with intermittent jams slash, fallen logs and debris - silted in-no try at estimate.
13. Log jam and tree roots barrier - silted in - bed drop 3 ft - 200 yards below #1; 10 ft wide 5 ft long 5 ft high - 50% void,
14. Log jam - 15 ft wide 30 ft long 4 ft high - 99% void area - 1.1 mile upstream from the mouth of the creek.
15. 2 each log jams - 50 yards below #14 - barrier - silted in - bed drop 3 ft each 10 ft wide 5 ft long 5 ft high - 75% each void area,
16. Log jam and barrier - silted in-bed drop 4 ft - boulder log jam - 3/4 mile up of the mouth - 30 ft wide 10 ft long 5 ft high - 75% void area.

Jams and Barriers (continued)

17. Log Jam - 2/3 mile upstream of the mouth - 15 ft wide 10 ft long 4 ft void area 95%.
18. Log jam and barrier - heavily silted in - tied drop 8 ft - 100 yards up of the mouth - 15 ft wide 30 ft long 8 ft high - 65% void area. An 8 ft drop within 30 feet.
19. A natural rock (bed) falls - barrier - 10 ft high - 75 yards upstream of the mouth.
These are fallen logs - slash and debris. scattered throughout the stream at this time are not jams or barriers.

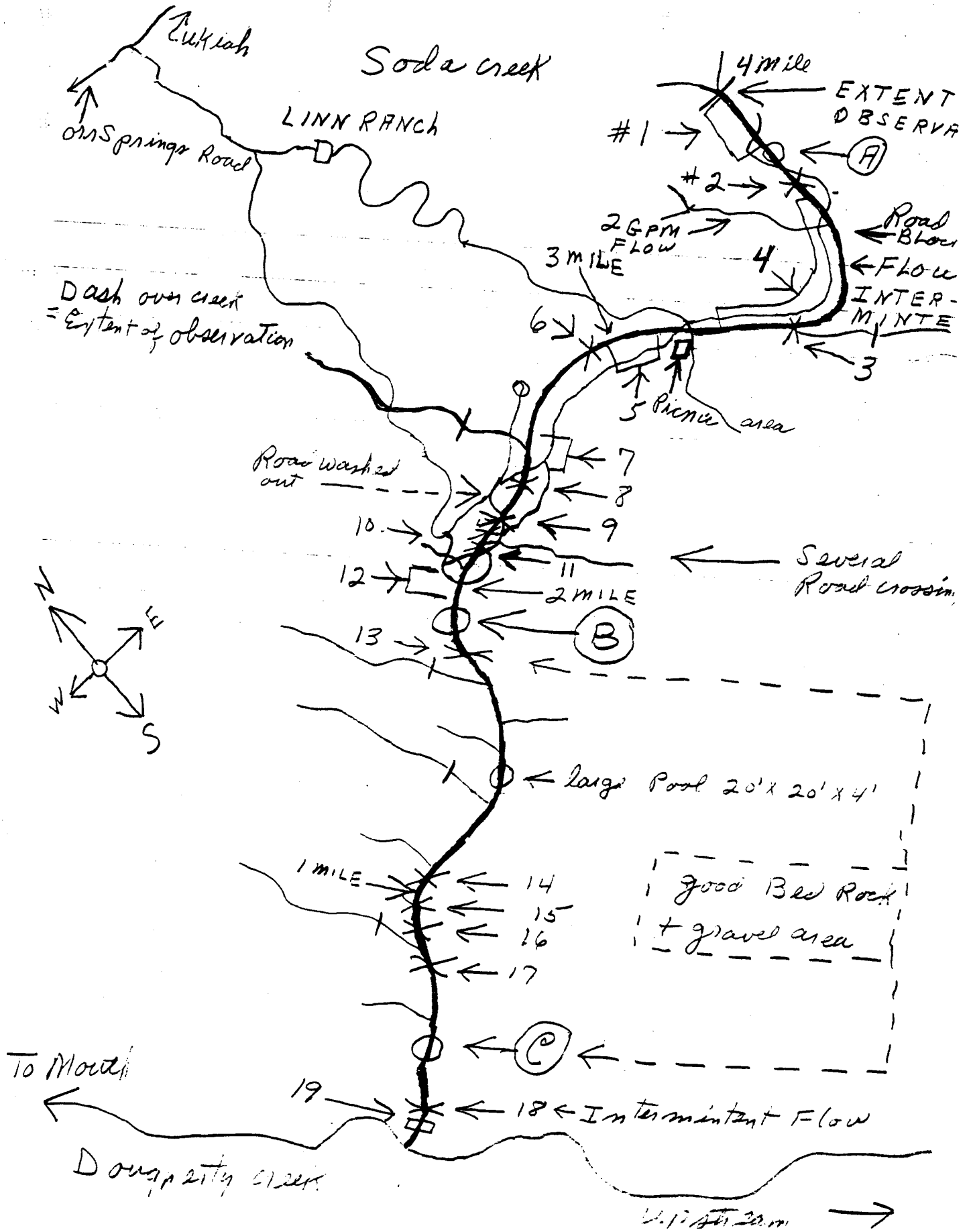

Dash over creek
= Extent of observation

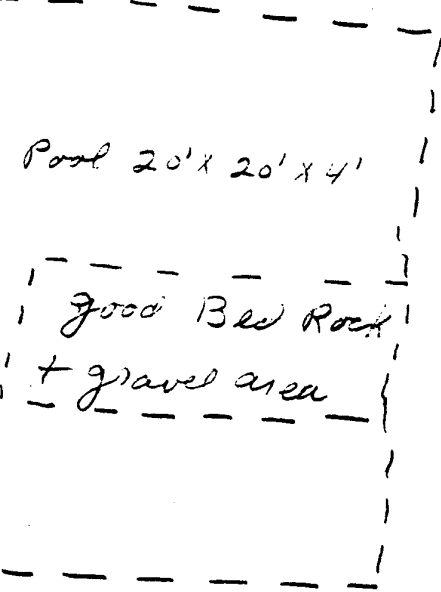
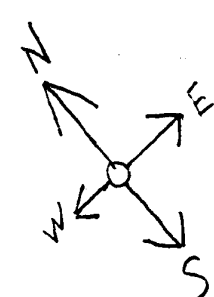

To Mouth

Dougherty Creek

U.S. 20 m →