

CALIFORNIA DEPARTMENT OF FISH AND GAME

**STREAM SURVEY**

FILE FORM

No.....

NAME..... PIG PEN GULCH..... COUNTY... Mendocino.....

STREAM SECTION..... FROM... mouth..... TO... extreme headwaters... LENGTH... 1-3/4.....

TRIBUTARY TO..... Big River..... Twp... 17N..... R... 14W..... Sec... 19.....

OTHER NAMES..... unknown..... RIVER SYSTEM... Big River.....

SOURCES OF DATA..... personal observations.....

<b>EXTENT OF OBSERVATION</b> Include Name of Surveyor, Date, Etc.
<b>LOCATION</b>
<b>RELATION TO OTHER WATERS</b>
<b>GENERAL DESCRIPTION</b>
Watershed
Immediate Drainage Basin
Altitude (Range)
Gradient
Width
Depth
Flow (Range)
Velocity
Bottom
Spawning Areas
Pools
Shelter
Barriers
Diversions
Temperatures
Food
Aquatic Plants
Winter Conditions
Pollution
Springs
<b>FISHES PRESENT AND SUCCESS</b>
<b>OTHER VERTEBRATES</b>
<b>FISHING INTENSITY</b>
<b>OTHER RECREATIONAL USE</b>
<b>ACCESSIBILITY</b>
<b>OWNERSHIP</b>
<b>POSTED OR OPEN</b>
<b>IMPROVEMENTS</b>
<b>PAST STOCKING</b>
<b>GENERAL ESTIMATE</b>
<b>RECOMMENDED MANAGEMENT</b>
<b>SKETCH MAP</b>
<b>REFERENCES AND MAPS</b>

EXTENT OF OBSERVATION - This tributary was walked out from the mouth to the headwaters a distance of 1 1/2 miles on 5-29-59 by S. N. Nye.

LOCATION- This tributary heads approx. 2 1/2 miles south of Two Rock lookout and flows south to enter Big River one mile west of Martin Cr.

RELATION TO OTHER WATERS - This stream is a minor spawning tributary to the headwaters of the main branch of Big River.

GENERAL DESCRIPTION - Watershed and Immediate Drainage Basin - This tributary is located in a rugged mountainous redwood, Douglas fir drainage. The stream flows through a relatively small dense wooded lodged over forest. The forest contains redwood, Douglas fir, madrone, oak, willow, bay and chaparral.

Altitude - Unknown.

Gradient - Moderate in lower and middle section becoming steep in the headwaters section.

Depth - Average 2 inches - (1-2 in.).

Width - " 2 ft. (1-3 ft.).

Flow - " .16 cfs (5 gpm to .18 cfs)

Velocity - " rapid.

Bottom - " small -gravel, silt, sand, rubble and bedrock.

Spawning Areas - poor throughout (no desirable spawning areas in upper headwaters section ; fair to poor spawning areas in middle and lower section.

Pools - Good development. Abundant. Average 3' x 5' x 1 ft. consisting of bedrock, undercut banks, fallen logs and jams.

Shelter - Abundant in the form of riparian growth, heavy horsetail and undercut banks.

Barriers - See attached.

Diversions - Not observed.

Temperatures - Average 59° (55-63).

Food - Caddis fly, mayfly, stonefly, diptera and other unidentified insects appearing to be abundant.

Aquatic Plants - Not observed.

Winter Conditions - Appear to be mild and subject to normal heavy winter fluctuating runoff. Average bank 15' wide and 5' deep.

Pollution - Only heavy poor logging practice observed.

Springs - Common throughout middle section.

FISHES PRESENT AND SUCCESS - Only one 2-inch rainbow trout-steelhead observed below jam and barrier No 29. considered to be of no success.

Other Vertebrates - Frogs, snakes and deer abundant. Salamanders appear to be few in number.

FISHING INTENSITY - Unknown.

OTHER RECREATIONAL USE - Unknown.

ACCESSIBILITY - This stream is accessible by driving 13.3 miles on a narrow, winding narrow, steep, dirt road on Redwood Products Road through two locked gates to the upper

PIG PEN GULCH  
Mendocino County

creek crossing from Highway 20, 5.2 miles west of Willits. An alternate route is to travel 15.9 miles Highway 101 south of Willits out the Baechel Creek Rd. via Welch & Welch Road, via Martin Creek Road to lower creek crossing .

Three locked gates must be passed through on this alternate route.

OWNERSHIP- Frank Williams and the Redwood Products (Willits).

POSTED OR OPEN - Locked gates are on the access road. The locks on the gates belong to Welch & Welch. Jack Lewis and the Redwood Products Co.

IMPROVEMENTS - None observed.

PAST STOCKING - Unknown.

GENERAL ESTIMATE - This stream at present is in poor condition due to poor logging practices of past logging operations. Due to two barriers and lack of spawning gravel caused by heavy siltation, this stream is not used by anadromous fishes at present.

RECOMMENDED MANAGEMENT - It is questionable if this stream is of great enough value to remove the logging debris and return it to a spawning and nursery ground for anadromous fishes. Combination of logging damages and low flow raise the question in this reasoning. Probably the cost of rehabilitation of this stream/relation to the number of fishes that would use this stream would require some amount of reasoning before the debris removing was undertaken.

SKETCH MAP - See attached.

REFERENCES AND MAPS - Personal observations and California Division of Forestry 1948 Mendocino County south half map.

JOHN S. DAY/S.NYE:cd

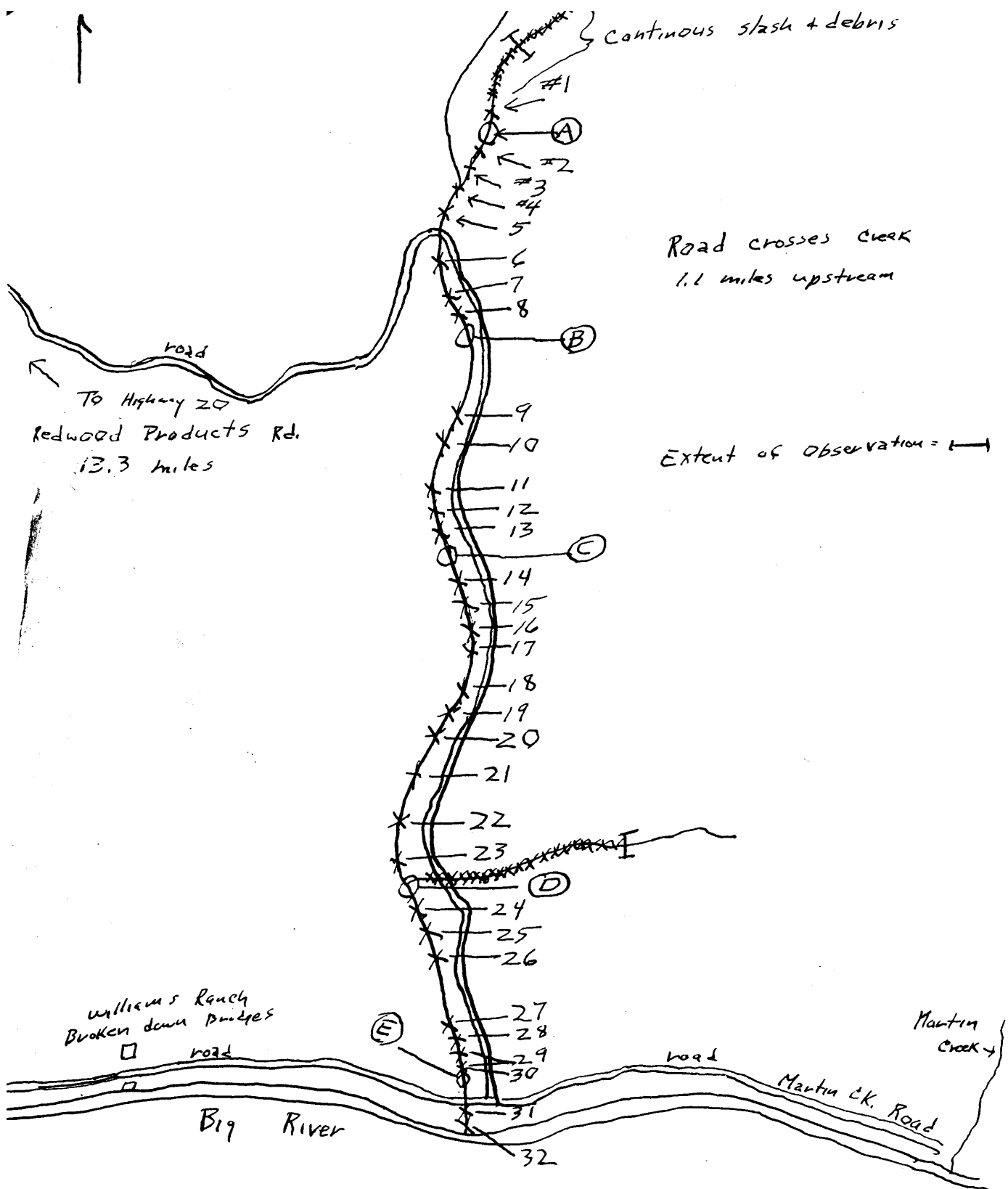

Continuous slash + debris

Road crosses creek  
1.1 miles upstream

Extent of observation =

To Highway 20  
Redwood Products Rd.  
13.3 miles

Williams Ranch  
Broken down bridges

Big River

Martin Creek  
Martin Ck. Road